

# Township of Monroe Outfall Locations

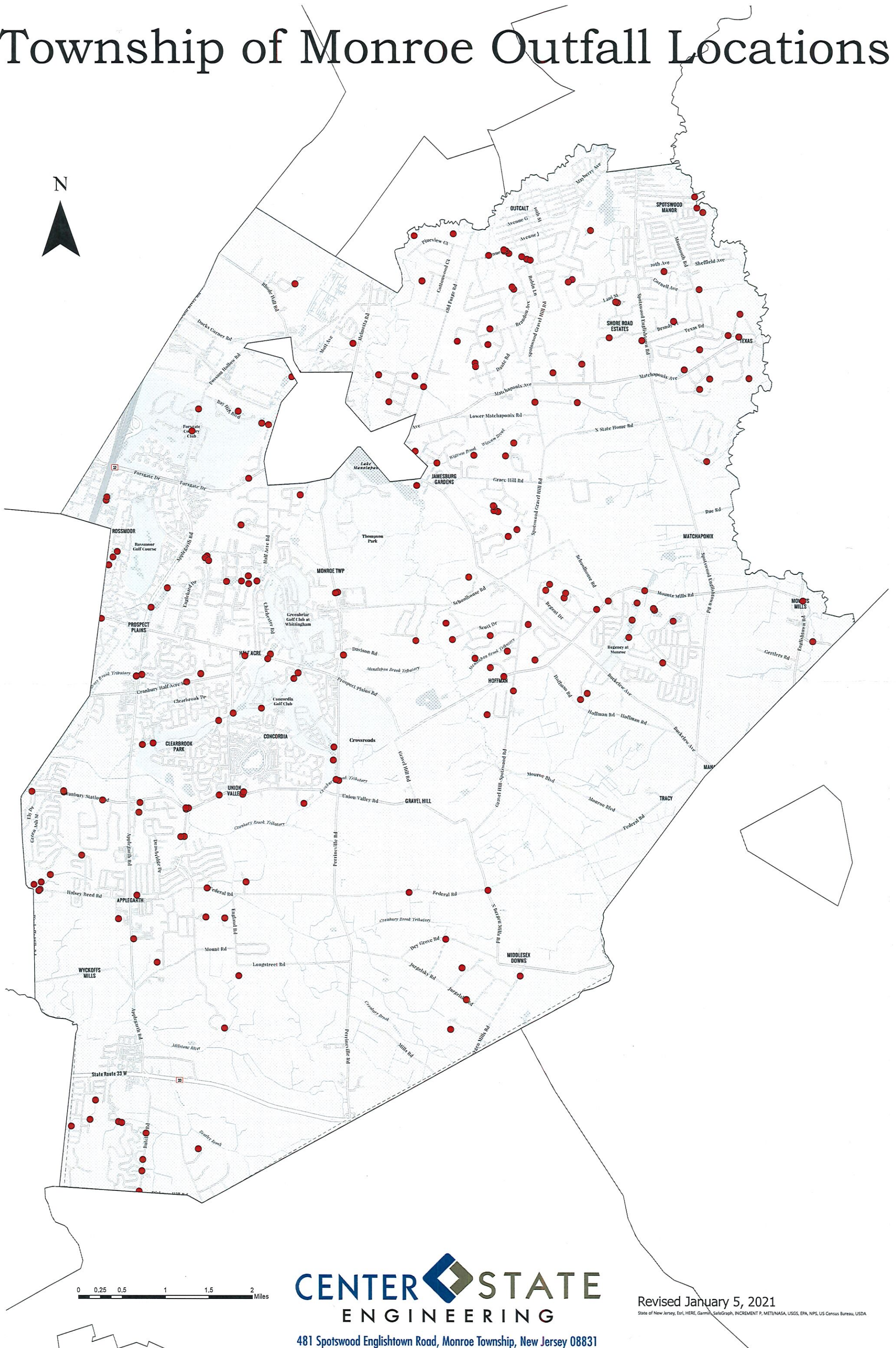

**CENTER STATE**  
ENGINEERING

481 Spotswood Englishtown Road, Monroe Township, New Jersey 08831  
T 732.605.9440 F 732.605.9444

Revised January 5, 2021

State of New Jersey, Esri, HERE, Garmin, SafeGraph, INCREMENT P, METI/NASA, USGS, EPA, NPS, US Census Bureau, USDA